

JESSICA SILVERMAN GALLERY

Julian Hoerber
The Inward Turn
November 6 – December 19, 2015

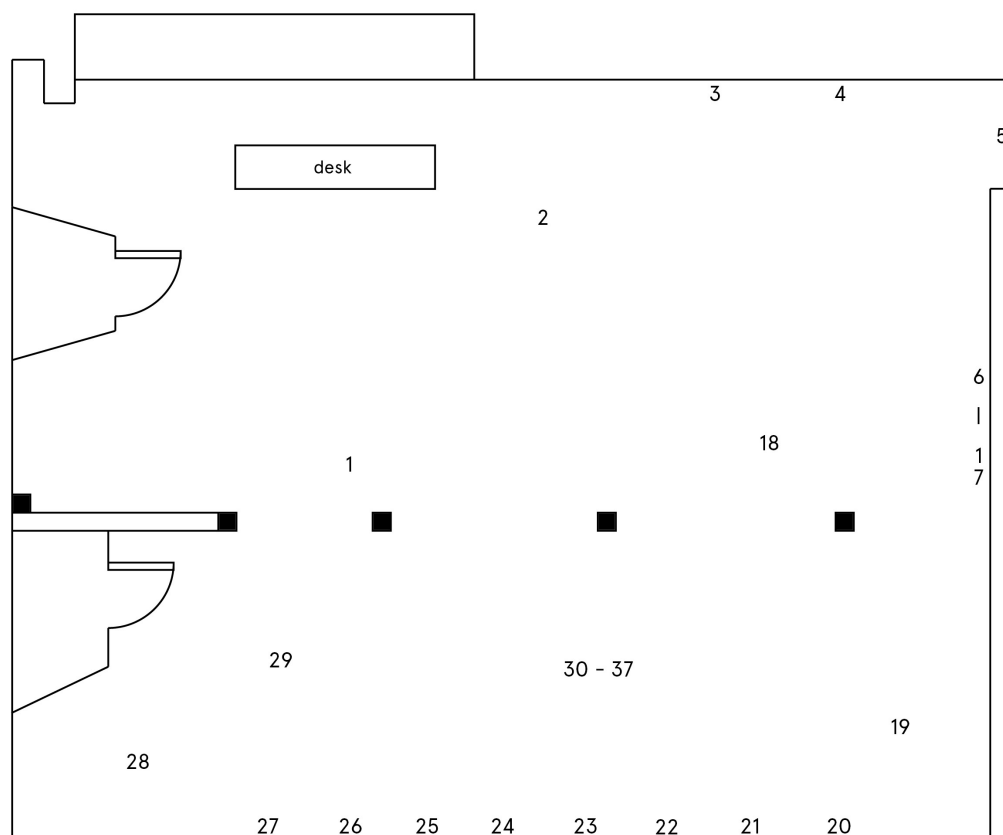

1. *Negative Space of Organ (Core)*, 2015

Sculpture: OSB, pine, foamcore, kozo, shellac, and hardware
Pedestal: Maple, glass, catalyzed oil finish
Sculpture: 25 x 25 x 22 inches (63.5 x 63.5 x 55.9 centimeters)
Pedestal: 38 x 28 x 16 inches (96.5 x 71.1 x 40.6 centimeters)

2. *Negative Space of Organ (Shell)*, 2015

Sculpture: OSB, pine, foamcore, kozo, shellac, and hardware
Pedestal: Maple, glass, catalyzed oil finish
Sculpture: 25 x 25 x 22 inches (63.5 x 63.5 x 55.9 centimeters)
Pedestal: 36 x 30 x 30 inches (91.4 x 76.2 x 76.2 centimeters)

3. *Form Index*, 2015

Materials variable
Installed dimensions variable
Shelving unit: 72 x 60 x 14 inches (182.9 x 152.4 x 35.6 centimeters)

JESSICA SILVERMAN GALLERY

4. *Going Nowhere Plan, version 2, 2015*

Graphite and flashe on paper

Framed: 27 1/4 x 22 in. (69.2 x 55.88 cm)

5. *Going Nowhere Vector Model, Bas Relief Tile, Second Level Complexity, Negative Spaces, 2015*

plywood, acrylic paint, brads, cotton string and MDF and plywood backing board

25 parts; 12 x 8 x 3 1/2 inches each (30.5 x 20.3 x 8.9 centimeters)

72 x 40 x 4 inches overall (182.9 x 101.6 x 10.2 centimeters)

Top row, from left to right:

6. *Angular to Curved Experiments 1&2, 2015*

Gouache and graphite on mulberry paper

Framed: 25 1/4 x 20 3/4 in. (64.1 x 52.7 cm)

7. *Bas-Relief Tile as Facade, 2015*

Gouache and graphite on mulberry paper

Framed: 20 x 15 1/4 in. (50.8 x 39.4 cm)

8. *Angular to Curved Experiments 3, 2015*

Gouache and graphite on mulberry paper

Framed: 11 1/4 x 23 1/2 in. (28.6 x 59.7 cm)

9. *Tile Facade Sketch, 2015*

Gouache and graphite on mulberry paper

Framed: 13 1/2 x 10 1/4 in. (34.3 x 26 cm)

10. *Floorplan Gut Experiments, 2015*

Gouache and graphite on mulberry paper

Framed: 19 1/2 x 19 1/2 in. (49.5 x 49.5 cm)

11. *Going Nowhere Plan, version 4, 2015*

Graphite and colored pencil on paper

Framed: 16 x 22 in. (40.6 x 55.88 cm)

Bottom row, from left to right:

12. *Going Nowhere Plan, version 1, 2015*

Graphite on paper

Framed: 13 1/2 x 16 1/4 (34.29 x 41.3 cm)

13. *Melanie Klein Bottle, 2015*

Graphite and gouache on mulberry paper

Framed: 20 1/4 x 15 1/4 in. (51.4 x 38.75 cm)

14. *Vectors as Curves and Gradients, 2007*

Gouache and graphite on cotton rag paper

Framed: 20 1/4 x 11 3/4 in. (51.4 x 29.8 cm)

JESSICA SILVERMAN GALLERY

15. *Going Nowhere Plan, version 3, 2015*

Graphite, colored pencil and flashe on paper
Framed: 22 1/4 x 27 in. (56.5 x 68.6 cm)

16. *Floorplan Studies, 2015*

Graphite, colored pencil and gouache on mulberry paper
Framed: 16 1/2 x 17 1/4 in. (41.9 x 43.8 cm)

17. *Cube into Spiral Experiment, 2015*

Graphite, colored pencil and gouache on mulberry paper
Framed: 15 1/2 x 20 1/4 in. (39.4 x 51.5 cm)

18. *Compound Curved Wall, 2015*

sculpture: Pigmented fiberglass reinforced ultracal cement
pedestal: walnut with catalyzed oil finish and glass
Sculpture: 5 parts; 16 x 84 x 12 inches overall (40.6 x 213.4 x 30.5 centimeters)
Pedestal: 37 x 114 x 29 inches (94 x 289.6 x 73.7 centimeters)

19. *Brutalist Organs, 2015*

sculpture: fiberglass reinforced ultracal cement with pigment and acrylic lacquer
pedestal: Oak with catalyzed oil finish and glass
Sculpture: Two parts; 24 x 24 x 24 inches each (61 x 61 x 61 centimeters)
Pedestal: 12 3/8 x 35 x 25 inches (31.4 x 88.9 x 63.5 centimeters)

20. *Spiral Floorplan, 2015*

Flashe and acrylic on linen with artist's frame
48 1/2 x 34 1/2 in. (123.2 x 87.6 cm)

21. *Ruminating Elevation 01, 2015*

Flashe and acrylic on linen with artist's frame
48 1/2 x 34 1/2 in. (123.2 x 87.6 cm)

22. *Intestinal Floorplan/Security Apparatus, 2015*

Flashe and acrylic on linen with artist's frame
48 1/2 x 34 1/2 in. (123.2 x 87.6 cm)

23. *Style Knot, 2015*

Flashe and acrylic on linen with artist's frame
48 1/2 x 34 1/2 in. (123.2 x 87.6 cm)

24. *Cardiac Section, 2015*

Flashe and acrylic on linen with artist's frame
48 1/2 x 34 1/2 in. (123.2 x 87.6 cm)

25. *Triple Klein Bottle Cross Section, 2015*

Flashe, colored pencil and acrylic on linen with artist's frame
48 1/2 x 34 1/2 in. (123.2 x 87.6 cm)

JESSICA SILVERMAN GALLERY

26. *Plumbing*, 2015

Flashe, acrylic and graphite on linen in artist's frame
48 1/2 x 34 1/2 in. (123.2 x 87.6 cm)

27. *Ruminating Elevation 02*, 2015

Flashe and acrylic on linen with artist's frame
48 1/2 x 34 1/2 in. (123.2 x 87.6 cm)

28. *Scholar's Rock Proxy*, 2015

sculpture: pigmented and unpigmented ultracal cement, and acrylic lacquer
pedestal: Cherry wood with catalyzed oil finish and MirroView glass
Sculpture: 18 x 22 3/4 x 30 inches (45.7 x 57.8 x 76.2 centimeters)
Pedestal: 12 1/2 x 29 x 46 inches (31.8 x 73.7 x 116.8 centimeters)

29. *Negative Space of Compound Curved Wall*, 2015

sculpture: Birch plywood, polyurethane rigid foam, epoxy, pigment and polyester resin
pedestal: Oak veneer plywood, MDF, latex paint, and lacquer
Sculpture: 24 x 16 x 12 inches (61 x 40.6 x 30.5 centimeters)
Overall: 54 x 20 x 16 inches (137.2 x 50.8 x 40.6 centimeters)

30. *Thought of Forms/Form of Thoughts 01*, 2015

Foamcore, kozo, and shellac
8 3/4 x 11 3/8 x 9 1/2 in. (22.2 x 28.9 x 24.1 cm)

31. *Thought of Forms/Form of Thoughts 04*, 2015

Foamcore, kozo, and shellac
18 3/4 x 12 1/2 x 12 1/2 in. (47.6 x 31.8 x 31.8 cm)

32. *Thought of Forms/Form of Thoughts 07*, 2015

Foamcore, kozo, and shellac
21 1/2 x 19 x 14 in. (54.6 x 48.3 x 35.6 cm)

33. *Thought of Forms/Form of Thoughts 02*, 2015

Foamcore, kozo, dowels and shellac
23 1/4 x 10 3/8 x 11 3/4 in. (59 x 26.4 x 29.8 cm)

34. *Thought of Forms/Form of Thoughts 03*, 2015

Foamcore, kozo, and shellac
11 7/8 x 11 1/4 x 7 1/2 in. (30.2 x 28.6 x 19.1 cm)

35. *Thought of Forms/Form of Thoughts 05*, 2015

Foamcore, kozo, dowels and shellac
21 x 25 1/2 x 19 in. (53.3 x 64.8 x 48.3 cm)

36. *Thought of Forms/Form of Thoughts 06*, 2015

Foamcore, kozo, and shellac
22 x 11 1/2 x 11 in. (55.9 x 29.2 x 27.9 cm)

JESSICA SILVERMAN GALLERY

37. *Thought of Forms/Form of Thoughts 08*, 2015
Foamcore, kozo, dowels and shellac
23 1/2 x 14 x 27 in. (59.7 x 35.6 x 68.6 cm)

Back room:

38. *LIMB/LIMP*, 2015
Latex enamel on laminated plywood
36 x 24 x 4 in. (91.4 x 61 x 10.2 cm)

39. *Ten Form Experiments*, 2015
Gouache and graphite on mulberry paper
21 x 35 3/4 in. (53.3 x 90.8 cm)