

PUBLICATION

Mari Slaattelid

Templates

Texts: Mari Slaattelid, Steinar Sekkingstad,

Aleksi Mannila-Wildhagen

Editors: Steinar Sekkingstad, Axel Wieder

Design: Sara De Bondt

Published by Bergen Kunsthall, Kunstnernes Hus and

Sternberg Press, 2019

The Festival Exhibition is presented this year in collaboration with Kunstnernes Hus in Oslo, where a new version of the exhibition will be shown in 2020. The two exhibitions have been planned as successive chapters with a focus on different aspects of Slaattelid’s most recent paintings. A new book is published in collaboration between Bergen Kunsthall and Kunstnernes Hus, including paintings from both exhibitions.

EDITION

Mari Slaattelid

Edition, Kystverket

2019

Acrylic on paper

41,7 x 29,5 cm

Edition of 10, unique

Mari Slaattelid’s edition for Bergen Kunsthall consists of 10 unique paintings on paper, made as variations over the main visual motif in the exhibition “Kystverket”. A male figure – seen in the paintings within the exhibition, where he is positioned in a mast high above the ground – is in these versions depicted in a much closer view, seen from behind, and without the mast’s visible connection to the ground. Painted with rapid, expressive brush strokes, the works share a common colour palette of black, green, and yellow tones, but are nevertheless distinctly articulated, giving each of the 10 paintings its own unique character.

Bergen Kunsthall’s edition series offers artworks from Norwegian and international contemporary artists. All the works have been made especially for Bergen Kunsthall and all profits from the sales go to support Bergen Kunsthall’s programme and future projects.

Curated by Axel Wieder (Director) & Steinar Sekkingstad (Curator)	Ragna Haugstad (Reception), Ask Holmen (Tickets), Aleidis Houthoofd (Distribution), Andrea Grundt Johns (Tours), Sarah Jost (Tech), Hanna Elise Jozefiak (Tickets), Vilja Kjersheim (Tickets), Gudrun Kringlebotn (Tickets), Mai Lahn-Johannessen (Program Manager), Caroline Larikka (Tours), Øystein Larssen (Reception), Annabel Lee (Tickets),
Staff Åsa Bjørndal (Distribution), Oda Førde Braanaas (Prod.), Dino Dikic (Learning), Åsne Eldøy (Tech), Lars Hallaråker (Tickets), Sofia Marie Hamnes (Production Assistant), Thea Haug (Reception),	

Dillan Marsh (Tech), Hilde Marie Pedersen (Head of Education), Martin Midtbø Rokkones (Tickets), Tuva Mossin (Tours), Maria Rusinovskaya (Curator Live Program), Jonas Skarmark (Technical Manager), Henrik Skauge (Prod.), Einride Torvik (Gallery Manager), Siv Torvik (Cleaner),	Vegard Vindenes (Tech), Eric Alvin Wangel (Tech), Maja Zahl (Finance and Administration), Mia Øquist (Members), Tord Øyen (Reception), Stein-Inge Århus (Communication)
---	--

Design
Blank Blank

The Festival Exhibition

Mari Slaattelid

Kystverket

23. 5. – 11. 8. 2019

The Bergen International Festival Exhibition is considered the most prestigious exhibition commission for a Norwegian artist in his or her home country. The Festival Exhibition has been shown at Bergen Kunsthall since 1953, selected and organised by Bergen Kunsthall.

This year’s Festival Artist, Mari Slaattelid, is one of Norway’s most recognised painters. For almost three decades Slaattelid has insisted on the potential of painting, independently of changing trends and the shifting status of painting within artistic discourses. Without locking the medium into any particular formal idiom, she alternates with ease between figuration and abstraction, between expressive and conceptual painting, and the intersections of painting in relation to other art forms such as photography and literature.

Her exhibition “Kystverket” consists almost exclusively of new works created especially for the galleries of Bergen Kunsthall. The title reflects the main motif in many of the new paintings: a coastal landscape with a lantern (navigation marker) and – in silhouette against the sky – an operator adjusting the light signal. With clear resonance in its geographical location on the coast of southwestern Norway, the exhibition can be seen as a site-specific response to the expectations and the format of the Festival Exhibition. Throughout this extensive series of paintings, which use variations of the same theme, Slaattelid explores a wide-ranging painterly vocabulary. The motif – where an object in nature becomes an

Opens Thur 23 May 13:00 Free Opened by Director Axel Wieder in the presence of Her Majesty Queen Sonja	Tours Every Sunday 14:00 Every Sunday 13:00 for Families
---	---

BERGEN KUNSTHALL

anthropomorphic signal emitter – is something she shares with colleagues from the history of art, such as August Strindberg and Peder Balke in Nordic painting. The distinctive triangular shape of the lantern, as an alien element in the landscape, in combination with the male figure placed high above ground level, is an iconic juxtaposition, transcendental and at the same time utterly prosaic.

The gaze is a recurring theme in the exhibition, appearing both in the lantern motif, where a circle is inscribed in a triangle like an “all-seeing eye”, and in a series of works depicting a human eye. The eye appears here as something bodily direct, and as an image of the individual gaze: the filter through which every one of us experiences the world.

Mari Slaattelid, (b. 1960), studied at the academies of art in Bergen, Oslo and Düsseldorf. She lives and works in Oslo. Recent exhibitions include among others STANDARD (OSLO), Oslo; Astrup Fearnley Museet, Oslo; Nasjonalmuseet, Oslo; Linköping konsthall, Linköping; Henie Onstad Kunstsenter, Bærum; Stavanger Kunstmuseum; Statens Museum for Kunst, København; Museum of Contemporary Art Kiasma, Helsinki; CAC, Vilnius; Malmö Kunstmuseum, Malmö; and Galleria d’Arte Moderna Bologna, Bologna.

Curated by Axel Wieder og Steinar Sekkingstad.

Plattform Sat 25 May 14:00 Free Mari Slaattelid in conversation with Gunnar Danbolt	Plattform Sat 10 Aug 14:00 Free Sigrun Åsebø, <i>Lovnader om lykke: Mari Slaattelid og rekonseptualisering av maleriet</i> , Lecture
---	---

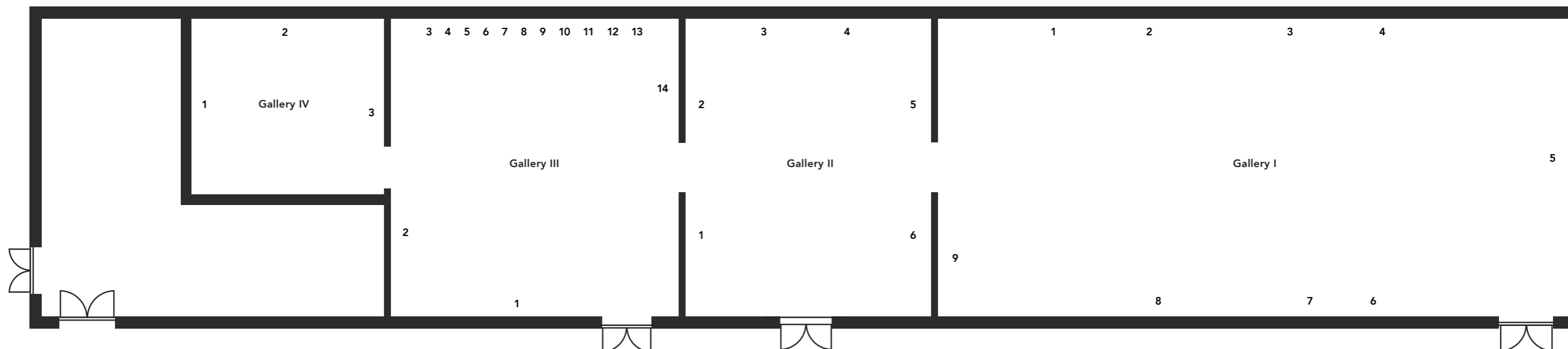
**Gallery IV**

1 *Eye on Paper 11*, 2017
Acrylic on paper
41,7 x 29,5 cm

Eye on Paper 13, 2017
Acrylic on paper
41,7 x 29,5 cm

Eye on Paper 12, 2017
Acrylic on paper
41,7 x 29,5 cm

Eye on Paper 10, 2017
Acrylic on paper
41,7 x 29,5 cm

2 *Lantern 10*, 2019
Acrylic and oil on primed
cotton canvas
185 x 180 cm

3 *Rose Fingered*, 2018
Oil on linen canvas
180 x 150 cm

Gallery III

1 *Lantern 9*, 2019
Acrylic and oil on cotton
canvas. 200 x 250 cm

2 *Templates 5*, 2018
Acrylic and oil on cotton
canvas. 200 x 220 cm

3 *Eye on Paper 5*, 2017
Acrylic on paper
41,7 x 29,5 cm

4 *Eye on Paper 22*, 2017
Acrylic on paper
41,7 x 29,5 cm

5 *Eye on Paper 4*, 2017
Acrylic on paper
41,7 x 29,5 cm

6 *Eye on Paper 7*, 2017
Acrylic on paper
41,7 x 29,5 cm

7 *Eye on Paper 24*, 2017
Acrylic on paper
41,7 x 29,5 cm

8 *Eye on Paper 9*, 2017
Acrylic on paper
41,7 x 29,5 cm

9 *Eye on Paper 1*, 2017
Acrylic on paper
41,7 x 29,5 cm

10 *Eye on Paper 3*, 2017
Acrylic on paper
41,7 x 29,5 cm

11 *Eye on Paper 23*, 2017
Acrylic on paper
41,7 x 29,5 cm

12 *Eye on Paper 8*, 2017
Acrylic on paper
41,7 x 29,5 cm

13 *Eye on Paper 2*, 2017
Acrylic on paper
41,7 x 29,5 cm

14 *Kystverket. Basic Figure*, 2019
Acrylic on linen canvas
200 x 135 cm

Gallery II

1 *Lantern 2*, 2018
Acrylic on glued linen
235 x 145 cm

2 *Lantern 6*, 2019
Acrylic on glued linen
235 x 135 cm

3 *Lantern 3*, 2018
Acrylic and oil on glued linen
235 x 145 cm

4 *Lantern 1*, 2018
Acrylic on glued linen
235 x 145 cm

5 *Lantern 7*, 2019
Acrylic and oil on glued linen
235 x 145 cm

6 *Lantern 4*, 2018
Acrylic and oil on glued linen
235 x 145 cm

Gallery I

1 *Blue Template*, 2019
Acrylic and oil on cotton
canvas. 230 x 195 cm

2 *Kystverket 4*, 2018
Acrylic and oil on linen canvas
230 x 195 cm

3 *Kystverket on Paper 3*, 2014
Acrylic on primed paper
100 x 100 cm

4 *Kystverket 3*, 2018
Acrylic and oil on linen canvas
230 x 195 cm

5 *Kystverket 2*, 2018
Acrylic and oil on cotton
canvas. 220 x 200 cm

6 *Kystverket on Paper 2*, 2014
Acrylic on primed paper
100 x 100 cm

7 *Kystverket on Paper 1*, 2014
Acrylic on primed paper
100 x 100 cm

8 *Lantern 8*, 2018
Acrylic and oil on cotton
canvas. 200 x 280 cm

9 *Kystverket 1*, 2018
Acrylic on cotton canvas
230 x 200 cm