

**Abigail Aroha Jensen** (Aotearoa NZ)

**Brook Konia** (Aotearoa NZ)

**Cathy Livermore** (Aotearoa NZ)

**Josephine Jelicich** (Aotearoa NZ)

**Qianhe 'AL' Lin** (Aotearoa NZ)

**Qianye Lin** (Aotearoa NZ)

**Rachel Shearer** (Aotearoa NZ)

**Tira Walsh** (Aotearoa NZ)

**Ufuoma Essi** (UK)

**Wukun Wanambi** (Yirrkala)

**curated by James Tapsell-Kururangi**

(Aotearoa NZ)

# About the artists

## Abigail Aroha Jensen

Abigail Aroha Jensen (Ngāti Porou through Te Whānau-a-Tūwhakairiora and Te Whānau-a-Ruataupare; Ngāi Tāmanuhiri through Rangiwaho; Crow and Steele clan, County Antrim) is an artist who places herself within her whakapapa by responding to space with oro – sound – painting and installation. Previous exhibitions in Tāmaki Makaurau Auckland include *Occupied territories* at RM gallery with Avigail Allan and Naomi Allan; *Manawa i te Kāniwha*, a mural produced in collaboration with George Watson for Artspace Aotearoa; and *Pūtahitanga Kura*, an artwork produced by Jensen and Watson for The Lightship, a digital light wall along Bledisloe Wharf.

## Brook Konia

Brook Konia (Ngati Porou, Kōtimana, Pākehā) is a curator and writer who focuses on contemporary Māori art. He has previously worked as Assistant Curator Modern and Contemporary Māori Art at Te Papa Tongarewa Museum of New Zealand, curator intern for *Toi Tū Toi Ora: Contemporary Māori Art* at Auckland Art Gallery Toi o Tāmaki and exhibition attendant for Dane Mitchell's 2019 Venice Biennale presentation, *Post Hoc*. He is currently studying towards a Masters of Māori Visual Arts at Massey University's Toiho ki Āpiti and is a trust member for Enjoy Contemporary Art Space.

## Cathy Livermore

Cathy Livermore (Waitaha, Kati Mamoe, Kai Tahu, English, Irish, Scandinavian) is an artist, educator, activist and healer. Over the past 20 years, she has pursued an artistic and pedagogical practice that explores the impacts of social and environmental constructs on our experiences of connection and purpose. Through kaupapa Māori and intercultural spaces of collaboration, Livermore questions the dynamic impacts of postcolonial realities on our identity and worldviews. As an educator, Livermore has developed pedagogies that incorporate kaupapa Māori and Pasifika worldviews within tertiary performing arts programmes in Aotearoa and has also developed Mauri Tau, an embodied wellbeing practice shaped by a Māori cultural worldview.

## Josephine Jelicich

Josephine Jelicich has participated in exhibitions at Precinct 35, Te Whanganui-a-Tara Wellington; 5hell, Tāmaki Makaurau Auckland; and The Physics Room, Ōtautahi Christchurch. She graduated with a BFA (Honours) from the College of Creative Arts Toi Rauwhāangi at Massey University and in 2019 completed the Furniture Makers' Programme at The Centre for Fine Woodworking, Whakatū Nelson. She makes furniture and art alongside her work as a gallery technician.

## Qianye Lin & Qianhe 'AL' Lin

Qianye Lin and Qianhe 'AL' Lin are an artist duo and siblings who work with audio-visual installation, writing and performance. They are interested in language, perspectives and storytelling in the embodiment of a fragmented linguistic experience. Their artworks have been exhibited at The Physics Room, Ōtautahi Christchurch; Coastal Signs, Tāmaki Makaurau Auckland; and Papatūnga, Tāmaki

Makaurau Auckland. In 2021, a book accompanying their moving-image artwork *Thus the Blast Carried It, Into the World* was co-published by Coastal Signs and New Public.

## Rachel Shearer

Rachel Shearer (Pākehā, Rongowhakaata, Te Aitanga ā Māhaki) is an artist researching sound as a medium through installation, composing, recording, performance, writing and moving image. She also collaborates as a sound designer and composer for moving-image and live performance events.

## Tira Walsh

Tira Walsh (Ngāti Wairere, Ngāti Hāua) is a painter whose practice focuses on translating the complex and clashing physical sensations of being in the world, drawing influence from cinema, popular music and everyday life. Walsh's work has been exhibited at Sydney Contemporary; Two Rooms, Tāmaki Makaurau Auckland; The Vivian, Matakana; Wallace Arts Centre, Tāmaki Makaurau Auckland; Gallery 9, Sydney; and Sanderson Contemporary, Tāmaki Makaurau Auckland. She has been awarded residences at Altes Spital in Solothurn, Switzerland through the Kaipara Wallace Arts Trust Award and at the Karekare House, supported by Eden Arts.

## Ufuoma Essi

Ufuoma Essi is a video artist and filmmaker from south-east London, whose work spans film, moving image, photography and sound. Using the archive as an essential medium, her work revolves around Black feminist epistemology and the configuration of displaced histories, with the aim of interrogating and disrupting the silences and gaps of political and historical narratives. Previous exhibitions and screenings include South London Gallery; Museum of Contemporary Art, Los Angeles; Black Star Film Festival, Philadelphia; Maysles Documentary Center, New York; Barbican, London; Lisson Gallery, London;

and Chisenhale Studios, London.

## Wukun Wanambi

Wukun Wanambi is an artist and Cultural Director at The Mulka Project, which he has led since its inauguration in 2007. He is renowned for reviving the saltwater imagery of his arm of the Marrakulu clan, which had not been painted intensively since his father's death in 1981. Wanambi has received multiple awards and has been heavily involved in major communal projects, including the Sydney Opera House commission and the opening of the National Museum of Australia. His bark paintings, larrakitj (burial poles) and multimedia projects have been exhibited at Raft Artspace, Darwin; the Art Gallery of South Australia; and the Sydney Biennale.

# About the curator

## James Tapsell-Kururangi

James Tapsell-Kururangi (Te Arawa, Ngāti Whakaue, Ngāti Pikiao, Ngāti Mākino, Tainui, Ngāti Raukawa, Ngāti Porou, Te Whānau-a-Rākairoa) is a curator, artist and writer currently working as assistant curator at Te Tuhi. His curatorial practice centres local Māori histories and focuses on building relationships within the community of artists he works with. His artistic practice is built from his whakapapa, in which he composes waiata that he frames within moving image artworks. He is also curator of the independent art space Papatūnga at Parnell Station, Tāmaki Makaurau.

# List of works

## Galleries

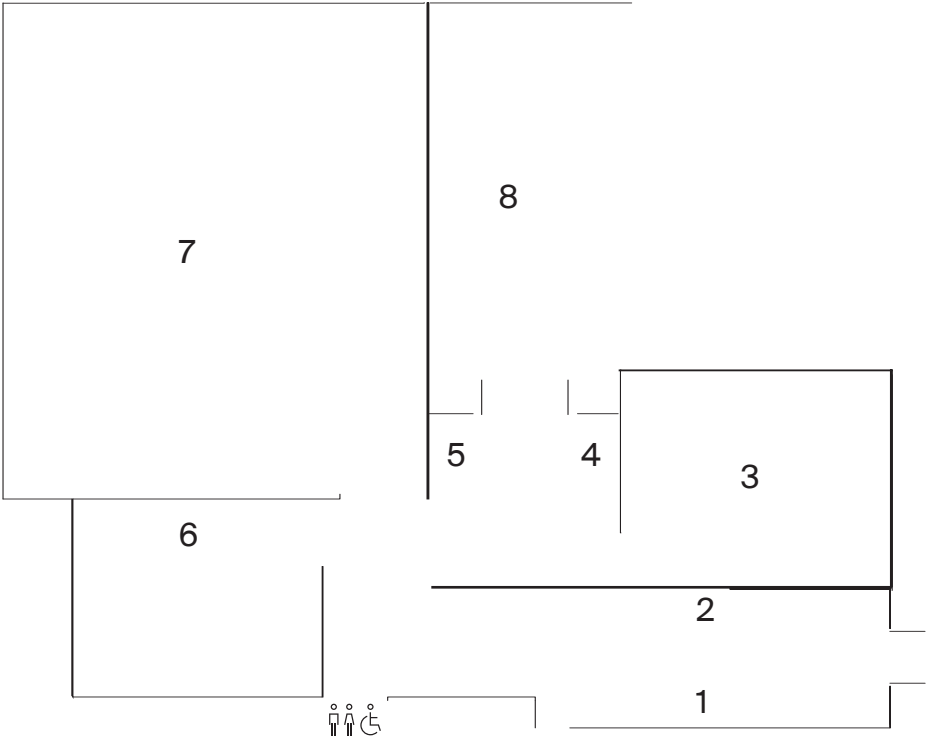

1. Tira Walsh  
*Black out Days*, 2022  
mixed-media on board  
9 x 2450 x 1200mm  
commissioned by Te Tuhi, Tāmaki Makaurau  
Auckland
2. Josephine Jelicich  
*Messages from the Stars*, 2022  
brushed aluminium, perspex, glass  
10820 x 2970 x 320mm  
commissioned by Te Tuhi, Tāmaki Makaurau  
Auckland
3. Rachel Shearer & Cathy Livermore  
with Pita Turei (Ngai Tai Ki Tamaki, Ngāti Pāoa, Ngā  
Rauru Kiiitahi)  
*Te Huri Wai*, 2021  
eight-channel audio  
originally commissioned for The Physics Room,  
Ōtautahi Christchurch
4. Brook Konia  
*I can see the universe from my house*, 2022  
text  
commissioned by Te Tuhi, Tāmaki Makaurau  
Auckland
5. Wukun Wanambi  
*Nhina Nhāma ga Njāma*, 2014  
video  
10 mins 21 secs
6. Ufuoma Essi  
*Bodies in Dissent*, 2021  
scanned Super8, colour  
5 mins 51 secs
7. Qian-ye Lin & Qianhe 'AL' Lin  
人參果之歌 *A Very True Heart*, 2022  
three-channel video  
7 mins 16 secs

commissioned by Te Tuhi, Tāmaki Makaurau  
Auckland

8. Abigail Aroha Jensen

*Inside my Papahou, ngā āhuratanga o te kuku o te  
tangata e te kēhua, 2022*

sound, concrete, iron oxide

4 x 1000 x 400 x 400mm

commissioned by Te Tuhi, Tāmaki Makaurau  
Auckland







Supporters & partners

**TE AHUREI | AUCKLAND**  
**TOI O TĀMAKI | ARTS FESTIVAL**

Principal funders

