

		Alison O'Daniel 26.06.21-03.10.21	OSNABRÜCK DIE FRIEDENSTADT
We Cannot Skip This Part 26.06.21-27.02.22		sievertstiftung für wissenschaft & kultur	schweizer kulturstiftung prohelvetia
Sabrina Röthlisberger 26.06.21-03.10.21		Stiftung der Sparkasse Osnabrück	Slavs and Tatars 26.06.21-03.10.21
Stiftung Niedersachsen	Candice Lin 06.11.21-27.02.22	VGH Stiftung	Katrin Mayer 06.11.21-27.02.22

Barrierefreiheit

We Cannot Skip This Part

die Blaue Distanz in dialogue with: Vorstand des Behindertenforums Osnabrück, Yolande Zola Zoli van der Heide and Inga Zimprich

June 26, 2021-February 27, 2022

Film programme by curator Yolande Zola Zoli van der Heide: June 26-October 3, 2021

Film programme by curator Inga Zimprich: November 06, 2021-February 7, 2022

Artist-designed movie room in the new building of the Kunsthalle

The exhibition and mediation programme Accessibility [Barrierefreiheit] involves exhibitions in the Kunsthalle Osnabrück and in the urban space. Departing from its own past, the Kunsthalle aims to tackle the mechanisms of inclusion and exclusion in both society and art. In order to reflect on the meaning and relevance of the term in cultural production and its social responsibility as a fundamental concept of anti-discrimination in relation to ableism, classism, sexism and racism, accessibility is to be removed from its very bureaucratic character as perceived by the public. The invited artists,

cultural producers and activists have been working for a long time to develop additional spaces of cohesive and equal communities. As a cultural institution, we learn from their debates in order to allow for new and complex perspectives in our own structures.

With exhibitons by Alison O’Daniel, Slavs and Tatars, Candice Lin, Die Blaue Distanz and Sabrina Röthlisberger.

Inspired by the recently uncovered concrete ceiling in the new building, the artist duo die Blaue Distanz will transform the exhibition space into a stage-like underground parking garage that will function as both film lounge and meeting place for the entire duration of the exhibition. Elements of road traffic such as guidelines, markings, or barriers will be used by the artists to address the challenges of accessible exhibition making in an experimental way. The goal is to create a place of access diversity and partial power that rebels against a unilateral norm.

In various seating areas you can watch the films thematically selected by the curators Yolande Zola Zoli van der Heide and Inga Zimprich. The films will be translated into German, English, simple language, sign language, audio description, and Braille.

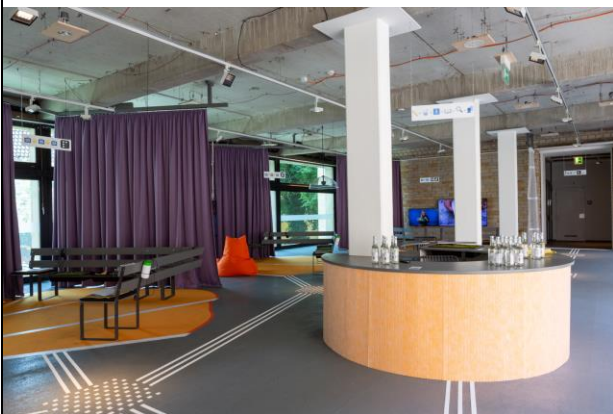

die Blaue Distanz, We Cannot Skip This Part, installation view Kunsthalle Osnabrück, 2021. Photo: Lucie Marsmann



die Blaue Distanz, We Cannot Skip This Part, installation view Kunsthalle Osnabrück, 2021. Photo: Lucie Marsmann

die Blaue Distanz (DE) is made up of Anna Erdmann and Franziska Goralski, who have been working together as a duo since 2016. In their artistic work they are interested in queer ways of living and learning. Both were part of the post-graduate master’s programme “The Commoners’ Society“ at the Sandberg-Instituut in Amsterdam from 2018–2020. Most recently, their work has been

shown at HAU Hebbel am Ufer, Berlin (2020), Festspielhaus Hellerau (2019), and Cities of Days, Los Angeles (2018), among others.

*Yolande Zola Zoli van der Heide is exhibitions curator at the Van Abbemuseum. Previously she was deputy director at Casco Art Institute: Working for the Commons, where she began as an intern in 2008. Her interests lie in diverse, intersecting perspectives and modes that decentre the oppressor in practices of freedom and liberation, and influence art institutional practices. She is co-editor of several books including *Unlearning Exercises: Art Organisations as Sites for Unlearning* (Casco Art Institute, Valiz, 2018); *Laure Prouvost, This Means Love* (Lisson Gallery, Van Abbemuseum, 2021).*

Inga Zimprich is a cultural worker, mother, and works as a care assistant in Berlin. She studied at the Gerrit Rietveld Academie Amsterdam, and the Jan van Eyck Academy Maastricht, as well as the Academy of Fine Arts, Leipzig. Together with Julia Bonn, she initiated the Feminist Health Research Group Berlin, which explores alternative models and methods of care and which conceives exhibitions, zines, and workshops. She is also part of the Sickness Affinity Group.

Kindly supported by Niedersächsisches Ministerium für Wissenschaft und Kultur, Stiftung Niedersachsen and Stiftung der Sparkasse Osnabrück.

Kunsthalle Osnabrück

www.kunsthalle.osnabrueck.de | Hasemauer 1 | 49074 Osnabrück |
Di-So 11:00-18:00

Press contact

Kristina Helena Pavićević | +49 (0)171 744 86 87 |
pavicevic@osnabrueck.de