

18F

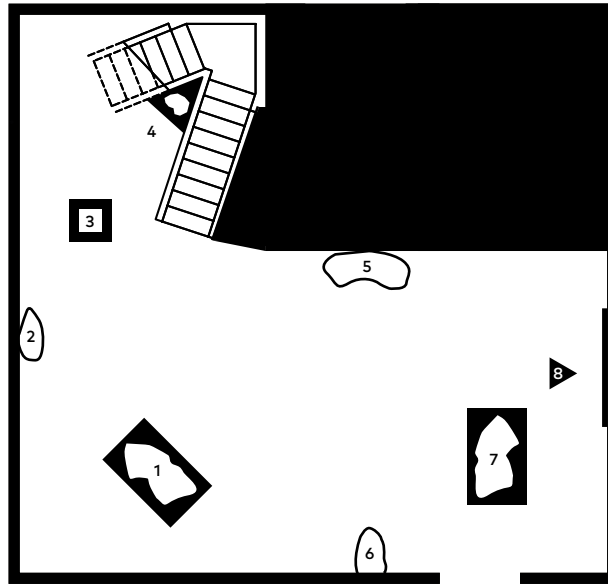

Jes Fan - Sites of Wounding: Chapter 1

1. ***Bivalve II***, 2023

Aqua resin, glass, pigment, metal
135.3 x 88.9 x 34.9 cm

2. ***Diagram XIX***, 2023

Aqua resin, glass, pigment
30.48 x 19.05 x 38.1 cm

3. ***C is for you***, 2023

Stainless steel, glass, osyter shells
19.5 x 19.5 x 32.5 cm

4. ***Left and right knee, grafted***, 2023

Aqua resin, glass, pigment
30.48 x 22.86 x 30.48 cm

5. ***Left torso, four times***, 2023

Aqua resin, glass, pigment, metal
93.98 x 35.56 x 91.44 cm

6. ***Left and right knees, three times***, 2023

Aqua resin, glass, pigment
22.86 x 30.48 x 124.46 cm

7. ***Bivalve I***, 2023

Aqua resin, glass, pigment, metal
131.13 x 82.87 x 48.9 cm

8. ***Palimpsest***, 2023

HD, sound
05:39

Video: Kai Ho Lee and Steve Mak
Audio: Geo Wyex