

Les fileuses
Élie Autin | Vidya Gastaldon
03.06. – 14.08.2023

Opening

Thursday 01.06.2023, 18:00

Opening hours

02.06. – 14.08.2023

Tuesday – Saturday, 14:00 – 18:00

Sunday 25.06.2023, 18:00 – 20:30

**Kashmir Yoga with Vidya Gastaldon
and sound performance by Nathalie Rebholz
by inscription only contact@circuit.li**

CIRCUIT

Centre d'art contemporain
av. de Montchoisi 9 (accès quai Jurigoz)
CP 303, CH-1001 Lausanne
+41 21 601 41 70
www.circuit.li

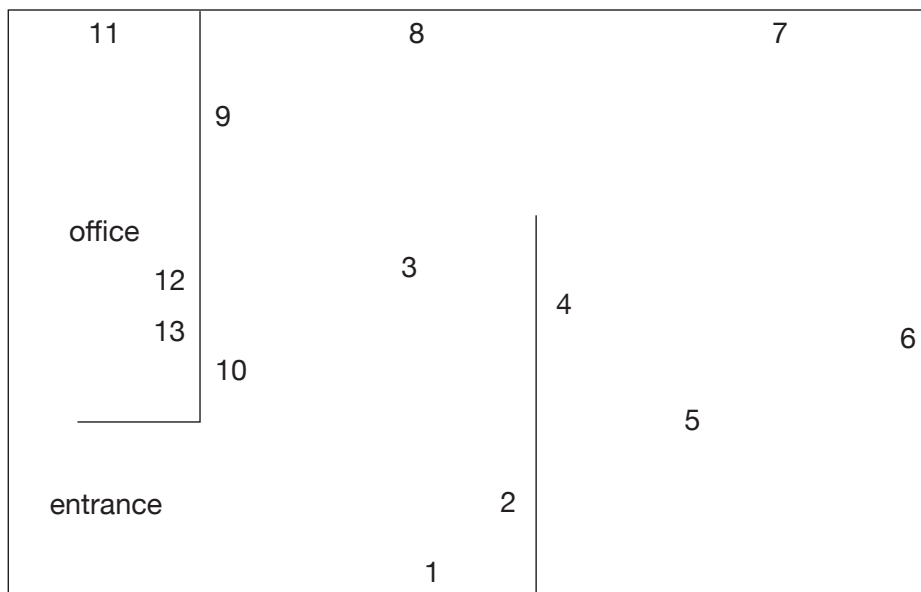

- | | | | |
|---|--|----|---|
| 1 | Vidya Gastaldon
<i>Déméter</i> , 2017
acrylic on canvas, 40 × 50 cm | 8 | Vidya Gastaldon
<i>Le "O"</i> , 2020-23
acrylic on canvas, painted frame, 55,5 × 47,5 cm |
| 2 | Vidya Gastaldon
<i>Mère Soleil</i> , 2023
acrylic on canvas, painted frame, 60,5 × 60,5 cm | 9 | Élie Autin & Aisha Devi
<i>Voices (Fearless Trance)</i> , 2022
audio, 9'21" |
| 3 | Vidya Gastaldon
<i>White Mixcoatl (Tenia)</i> , 2016
wool, beech sticks, thread and beads, 1180 × 20 cm | 10 | Vidya Gastaldon
<i>L'ouverture</i> , 2017
acrylic on canvas, 130 × 97 cm |
| 4 | Élie Autin
<i>Gardiennes</i> , 2023
wood and mushrooms found in the forest, masks, artist's braids, epoxy, glitter, spray paint
dimensions variable | 11 | Vidya Gastaldon
<i>Visionium Warmer</i> , 2022
14 fleece blankets
sublimation double print, 150 × 150 cm |
| 5 | Élie Autin
<i>L'arrivée</i> , 2023
mixed media, dimensions variable | 12 | Vidya Gastaldon
<i>Océan sentimental (mini)</i> , 2023
acrylic on canvas, 22 × 27 cm |
| 6 | Vidya Gastaldon
<i>Fille de (Anemone)</i> , 2023
acrylic on canvas, painted frame, 60,5 × 52,5 cm | 13 | Vidya Gastaldon
<i>Paysage sentimental (mini)</i> , 2023
acrylic on canvas, 22 × 27 cm |
| 7 | Vidya Gastaldon
<i>Océan sentimental (R)</i> , 2022
acrylic on canvas, 180 × 250 cm | | |