

● The Perimeter is proud to announce Lewis Hammond: *This Glass House*, the painter's first public exhibition in the UK. Through baroque and surrealist motifs, Hammond takes imaginative departure from both interpersonal relationships and global political events to create charged, fantastical works that mirror deeper realities. The exhibition will coincide with Frieze week, London.

Often fantastical, though always anchored in the present, Hammond's work recalls fleeting memories and dreamlike states, cast through a lens inspired by both the Baroque and Surrealist movements. They interweave scenes of myth alongside reality, often depicting half-human creatures inhabiting dark architectural worlds. The paintings are visual explorations of the body's interpersonal and individual relationships and operate a deeply enrapturing sense of otherness, navigating the fine line between existential dread and human comfort. Hammond's practice explores themes of stasis, interiority, and contemplation. With a central focus on corporeality and underscored by a tangible sense of the uncanny, his figurative paintings capture a moment frozen in time.

*This Glass House* travels to The Perimeter from the Kunstpalais in Erlangen, Germany. The second leg of the exhibition features several new works not exhibited in Germany.

Lewis Hammond (b. 1987, Wolverhampton, UK) is a British figurative painter who lives and works in Berlin. Hammond graduated from the Royal Academy Schools in 2017 where he explains he became enamoured by "the immediacy and relative flexibility of oil paint". This interest in exploring the materiality of oil paint is evident throughout Hammond's practice. With his discordant union of dark and earthy tones, the artist renders unsettling and statuesque figures, harking back to conventions established by artists such as Caravaggio, Velázquez and Goya.

Positioned within a liminal space between the individual and archetypal, Hammond's works play to the artist's unique interpretation of the Surrealist tradition. The fantastical aura of his pieces derive from

their symbolic potential, and the shifting perspectives from which they can be interpreted. The paintings encourage a sense of ritual and mythology, as the artist himself describes, they are "sideways reflections/representations of the complexities of lived experience — insecurity, anxiety, and the alarming socio-political landscape". Indeed, within his paintings, Hammond is "simultaneously mining and inventing, nothing is fixed."

The paintings in *This Glass House* are presented alongside a soundscape created by British musician Darren J. Cunningham a.k.a. Actress (b. 1979, Wolverhampton, UK). One of the most preeminent voices in UK electronic music, Actress credits a diverse array of genres, including early 1980s funk and electro, as well as house and noise. His music reaches disorienting heights, providing an apt soundtrack against which to view Hammond's captivating and unsettling pieces.

Hammond's work has been displayed internationally in several solo and duo exhibitions, including *This Glass House*, at Kunstpalais, Erlangen, Germany (2024); *Evocações, Ismael Nery and Lewis Hammond* at Mendes Wood DM, São Paulo, Brazil (2023); *ars viva, Agents of Perception* at Kai Art Center, Tallinn, Estonia (2022); *Rising and Falling (Whilst We Were Sleeping)* at HKFD, Holstebro, Denmark (2021); *While We Were Sleeping*, at Casa Masaccio, San Giovanni Valdarno, Italy, and *Still Life* at Lulu, Mexico City, Mexico (2020). Selected group exhibitions in which his paintings have been featured also include: *Wild Grass: Our Lives* at Yokohama Museum of Art, Yokohama, Japan (2024); *What The Dead Do* at Kunstverein Bielefeld, Bielefeld, Germany (2023); *Particularities* at X Museum, Beijing, China (2021); and *A House is Not a Home* at Kunsthalle Friart Fribourg, Fribourg, Switzerland (2019).









Bookings via our website:  
[theperimeter.co.uk/visit](http://theperimeter.co.uk/visit)



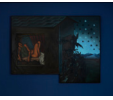

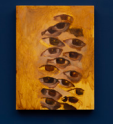

For press enquiries or images, please contact Scott & Co: [lydia@scott-andco.com](mailto:lydia@scott-andco.com)

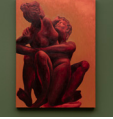
## THE PERIMETER

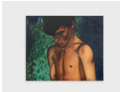
# EXHIBITION GUIDE

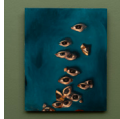
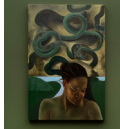
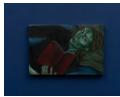
Lewis Hammond: *This Glass House*  
13 September – 20 December 2024

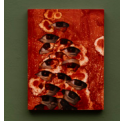
- 1  **Untitled, 2024**  
OIL ON LINEN, 100 X 140 CM  
COURTESY OF THE ARTIST AND  
ARCADIA MISSA, LONDON
- 2  **Flowering Orchids, 2024**  
OIL ON PANEL, 30 X 40 CM  
COURTESY OF THE ARTIST AND  
ARCADIA MISSA, LONDON
- 3  **Untitled (siren), 2024**  
OIL PAINT ON WOOD, VELVET  
AND PALM LEAF, 41.5 X 18.5 CM  
COURTESY OF THE ARTIST  
AND ARCADIA MISSA, LONDON
- 4  **insomnis, 2024**  
OIL ON LINEN, 230 X 310 CM  
COURTESY OF THE ARTIST,  
KUNSTPALAIS, ERLANGEN, DE,  
AND ARCADIA MISSA, LONDON
- 5  **Untitled, 2024**  
OIL ON LINEN, 140 X 90 CM  
COURTESY OF THE ARTIST AND  
ARCADIA MISSA, LONDON
- 6  **Untitled, 2024**  
OIL ON WOOD PANEL, 40 X 30 CM  
COURTESY OF THE ARTIST,  
KUNSTPALAIS, ERLANGEN, DE,  
AND ARCADIA MISSA, LONDON
- 7  **Untitled, 2024**  
OIL ON LINEN, 90 X 105 CM  
COURTESY OF THE ARTIST AND  
ARCADIA MISSA, LONDON
- 8  **pale interior, 2024**  
OIL PAINT ON WOOD, VELVET  
AND PALM LEAF, 3 PARTS, EACH:  
41.5 X 16.5 CM  
COURTESY OF THE ARTIST  
AND ARCADIA MISSA, LONDON
- 9  **Cruel Limbo 2022**  
OIL ON LINEN, 100 X 140 CM  
COURTESY OF THE ARTIST AND  
ARCADIA MISSA, LONDON
- 10  **Untitled (Nymph & Satyr),  
2024**  
OIL ON LINEN, 90 X 65 CM  
COURTESY OF THE ARTIST,  
KUNSTPALAIS, ERLANGEN, DE,  
AND ARCADIA MISSA, LONDON

- 11  **something to live for, 2024**  
OIL ON LINEN, 140 X 170 CM  
COURTESY OF THE ARTIST  
AND ARCADIA MISSA, LONDON
- 12  **ecstasts (St. T), 2024**  
OIL ON LINEN, 30 X 40 CM  
COURTESY OF THE ARTIST AND  
ARCADIA MISSA, LONDON
- 13  **samsara, 2024**  
OIL ON CANVAS, 230 X 140 CM  
COURTESY OF THE ARTIST,  
KUNSTPALAIS, ERLANGEN, DE,  
AND ARCADIA MISSA, LONDON
- 14  **Untitled, 2024**  
OIL ON COPPER, 50 X 40 CM  
COURTESY OF THE ARTIST,  
KUNSTPALAIS, ERLANGEN, DE,  
AND ARCADIA MISSA, LONDON
- 15  **Verhängnis, 2024**  
OIL ON LINEN, 90 X 60 CM  
COURTESY OF THE ARTIST,  
KUNSTPALAIS, ERLANGEN, DE,  
AND ARCADIA MISSA, LONDON
- 16  **Bow Down, 2024**  
OIL ON OAK PANEL, 69.5 X 47 CM  
COURTESY OF THE ARTIST,  
KUNSTPALAIS, ERLANGEN, DE,  
AND ARCADIA MISSA, LONDON
- 17  **Untitled, 2024**  
OIL ON LINEN, 20 X 30 CM  
COURTESY OF THE ARTIST,  
KUNSTPALAIS, ERLANGEN, DE,  
AND ARCADIA MISSA, LONDON
- 18  **Untitled (in search of  
equilibrium), 2024**  
OIL ON OAK LINEN, 190 X 150 CM  
COURTESY OF THE ARTIST,  
KUNSTPALAIS, ERLANGEN, DE,  
AND ARCADIA MISSA, LONDON
- 19  **Untitled (Europa,  
full of holes), 2024**  
OIL ON WOOD PANEL, 40 X 30 CM  
COURTESY OF THE ARTIST,  
KUNSTPALAIS, ERLANGEN, DE,  
AND ARCADIA MISSA, LONDON
- 20  **untitled, 2024**  
OIL PAINT ON WOOD, VELVET  
AND PALM LEAF, 32 X 16.5 CM  
COURTESY OF THE ARTIST  
AND ARCADIA MISSA, LONDON

### Ground Floor

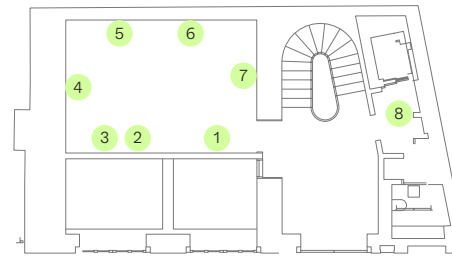

- 1 *Untitled, 2024*
- 2 *Flowering Orchids, 2024*
- 3 *Untitled (siren), 2024*
- 4 *insomnis, 2024*
- 5 *Untitled, 2024*
- 6 *Untitled, 2024*
- 7 *Untitled, 2024*
- 8 *pale interior, 2024*

### First Floor

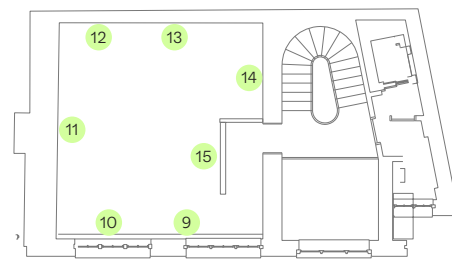

- 9 *Cruel Limbo, 2022*
- 10 *Untitled (Nymph & Satyr), 2024*
- 11 *something to live for, 2024*
- 12 *ecstasis (St. T), 2024*
- 13 *samsara, 2024*
- 14 *Untitled, 2024*
- 15 *Verhängnis, 2024*

### Second Floor

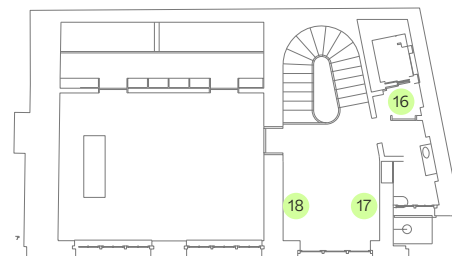

- 16 *Bow Down, Lewis Hammond, 2024*
- 17 *Untitled, Lewis Hammond, 2024*
- 18 *Untitled (in search of equilibrium), 2024*

### Archive

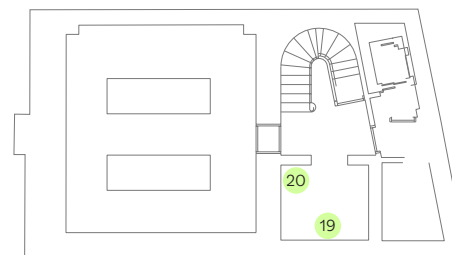

- 19 *Untitled (Europa, full of holes), 2024*
- 20 *untitled, 2024*