

KEITH COVENTRY

WORKS ON PAPER 1992 - 2024

8 - 16 NOVEMBER, 2024

Opening on Friday 8th November at The HORSE - *Works on paper 1992-2024* by British artist Keith Coventry. The exhibition draws a discreet survey of his practice over the past 32 years, including preparatory sketches and source material for his iconographic artworks.

Keith Coventry's paintings and sculptures are a direct response to familiar objects and footings within the contemporary social landscape. His appropriation of epochal material (fast food packaging, social living, addiction, print ephemera, media figures) is then consciously placed within the situation of modernism and, in turn post-modernism; the act is simultaneously humorous and serious.

*Works on paper 1992-2024* is an intimate show: Coventry allows us to see behind the known and finished paintings and sculptures. We are seeing the genesis of bodies of work as well as some entirely new evolutions on his well known tropes: *Junk Sketches*, *Estate Paintings*, *Crack Series* and some pieces of paper that we can see might have been in his wallet for years. A quiet Spectacle.

From 1992 *Ladybird Updates* are two pages taken from a kids book. The works convey subtle oppressive changes in the nature of the policing, the hi-vis arm bands and the evolution of the car behind; difference and repetition. From 2011 there is a series of *Junk Sketches*, drawn in coloured pencil, the shapes are partially filled in, skeletal, evoking a difference to the finished and familiar works. Amongst a series of *Estate Paintings* Coventry presents *Murder Estates*: these suprematist paintings compositionally select true crime scenes, rendered hard edge abstraction of buoyantly light and brilliant colours; A black humour between composition and source.

Keith Coventry's work was featured in the seminal exhibition *Sensation* at the Royal Academy of Arts, London, in 1997 and was a co-founder and curator of City Racing, an influential not-for-profit gallery in Kennington, South London from 1988-98. In 2006, Coventry received a mid-career retrospective at Glasgow's Tramway (Art Centre) and in 2010 was awarded the John Moores Painting Prize. His work has been exhibited widely in the United Kingdom and Europe and is included in collections worldwide, including the British Council; Tate Modern; Arts Council of England; Walker Art Center, Minneapolis; and The Museum of Modern Art, New York.

Founded in 2021 The Horse is an artist run contemporary art gallery in Dublin 1 that seeks to provide a platform for emerging, experimental and underrepresented art practitioners. For sales, viewings and programming in general, please email Matthew Wilkinson – [mw@thehosedublin.xyz](mailto:mw@thehosedublin.xyz)

WORKS ON PAPER 1992-2024

8th NOVEMBER - 16th NOVEMBER, 2024

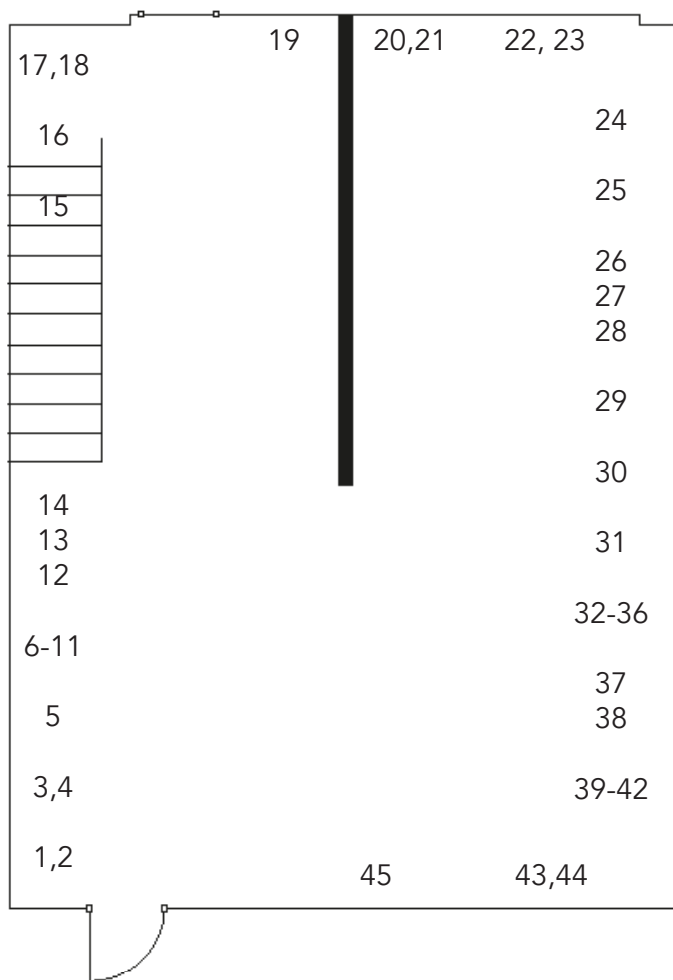

1,2	2xEstate source ink, graphite : 37 x 32 cm	1992	19	<i>Kate Moss Supermodel study</i>	2001
3,4	<i>Dptych (Ladybird updates)</i> appropriated prints : 33 x 24 cm	1992	20,21	<i>Crack Screenprints</i> 120 x 85 cm	2001
5	<i>Source for Hero paintings</i> ink : 32 x 44 cm	1994	22, 23	<i>Source for key Group cloths</i> magazine page, ink : 52 x 42 cm	2001
6-11	<i>1995 Brixton riot rubbings</i> wax crayon : 24 x 27 cm	1995	24	<i>Crumbs</i> litho & screenprint : 62 x 78 cm	2005
12-15	<i>Estate painting studies</i> oil stick, coloured pencil	2001	25	<i>Mc Donald drawings (study for paintings)</i> 2011 oil stick, coloured pencil : 42 x 52 cm	2011
16	<i>Royal family source for White in White painting</i> poster print : 72 x 54 cm	2007	26	<i>Mc Donald drawings (study for paintings)</i> 2011 graphite, coloured pencil : 26 x 31 cm	2011
17,18	<i>Crack bottle</i> photo etchings : 36 x 48 cm	1999	27	<i>Murder estate study</i> oil stick, coloured pencil : 32 x 38 cm	2011
			28	<i>Aylesbury estate</i> screenprint : 47 x 59 cm	2014
			29	<i>Kebab letter press prints</i> 38 x 51 cm	2013
			30	<i>Old comedy collage</i> lollipop sticks, tape, spraypaint : 42 x 52 cm	2019
			31	<i>Old comedy collage</i> lollipop sticks, tape, spraypaint : 42 x 52 cm	2019
			32-36	<i>Murder estates 1-4</i> lino print : 47 x 30 cm	2022
			37	<i>Mc Donald studies</i> guache : 37 x 72 cm	2023
			38	<i>Mc Donald studies</i> guache : 37 x 72 cm	2023
			39-42	<i>Mc Donald studies</i> guache : 32 x 36 cm	2023
			43,44		