

*As the world turns Hallelujah Electricity
will open at Good Weather
on Valentine's Day and
run until Good Friday 2025.*

A pod of pilot whales gathered in a heart formation maybe only for a few moments. This is several years ago now but you may remember the image taken from above. A year before there was something similar.

And then they mass suicided. 97 died in 2023 and then in subsequent years 54, 32, 150; but that time 135 were returned to deep water. It's not always possible to save them and anyway they usually do it again.

In Berlin, Lena told me she also feels collapsed but dealing all day with the hearts made her feel better somehow. In Flagstaff there was a "community valentine." A large decorated wooden heart that the recipient would get to have on their front lawn. I longed for it. You send me an article about the dispersed fate of heart shaped bathtubs, maybe it's my first public sculpture in the Poconos, anyway 'tis the season.

Dying Play was made in Hollywood in 2022 whilst I was living near these two old men who felt to me like they were dying. I felt like I was dying too, stewing in the sad molasses of that spring. Eventually I couldn't extract myself. We are all always already dying, remember that?

dust bunnies

Nancy Lupo (2025)

Hallelujah Electricity is a solo exhibition by Nancy Lupo at Good Weather and is on view until April 18, 2025, with gallery hours on Saturdays from 1–4 p.m. or by appointment.

Nancy Lupo
Hallelujah Electricity
February 14-
April 18, 2025

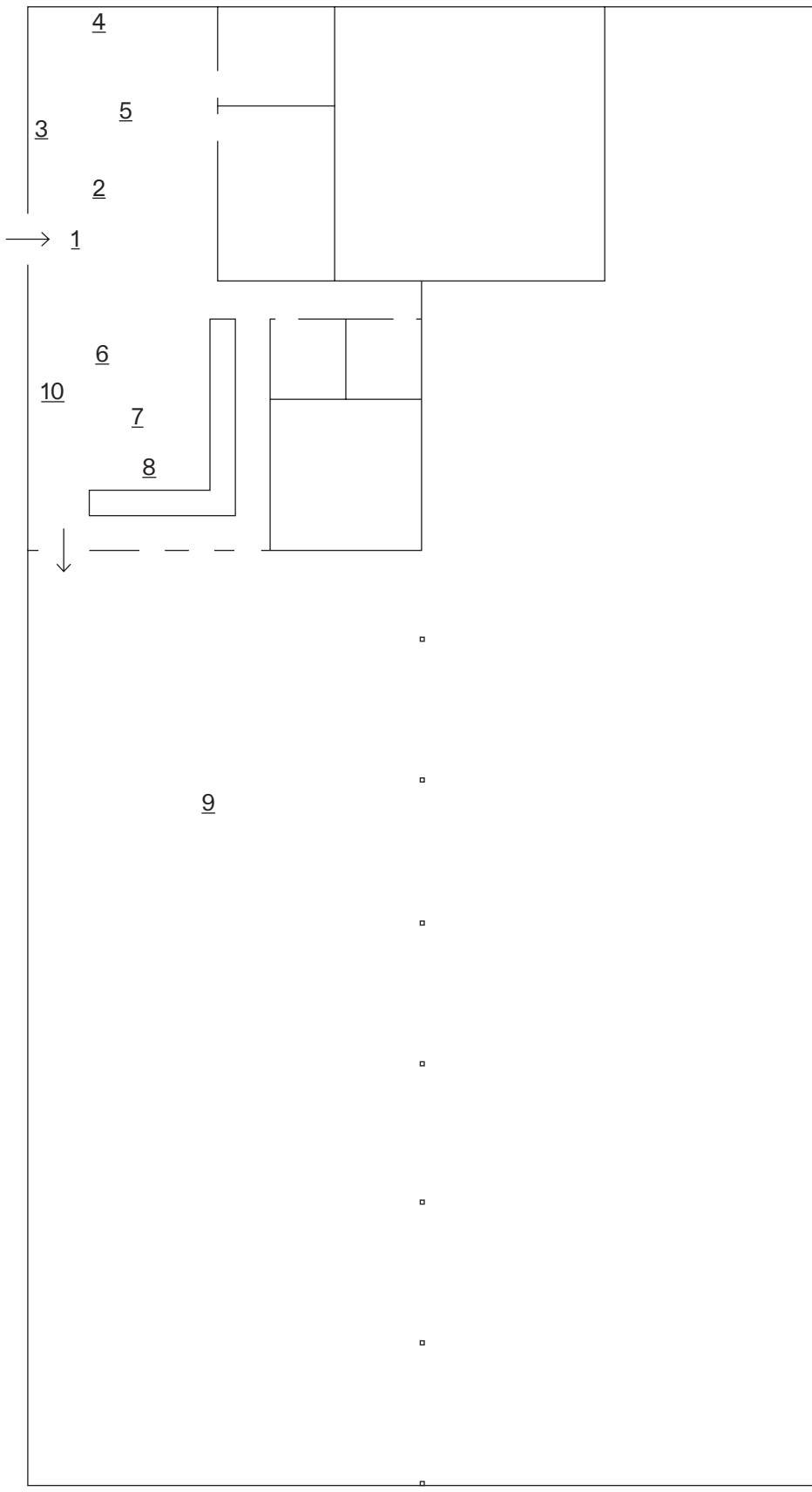

- 1
Margarita Pearl, 2025
Freshwater pearls
~113 × 118 in
- 2
Crazy Onceinalifetime, 2025
Bronze, plastic
~24 × 24 × 20 in
(2 elements)
- 3
Bones, 2025
Various Nylabone dog bones,
pearlescent paint, plastic
mourning figures, six tellers
(bamboo sticks, rice glue,
toilet paper, paper towels,
turmeric, graphite)
Dimensions variable
(32 elements)
~13 × 9.5 × 4 in each
(4 elements)
~9 × 10 × 3.5 in each
(2 elements)
- 4
Untitled, 2025
Aluminum, office tape
Dimensions variable
(3 elements)
~46 × 2 × 2 in each
(2 elements)
- 5
Leathers, 2025
Treated leather
~39 × 30 in each
(19 elements)
- 6
not yet titled, 2025
Toilet paper, glue, cast silicone,
two tellers (bamboo sticks, rice
glue, toilet paper, paper towels,
interference pigment)
~53 × 39 × 3 in
(3 elements)
~9.5 × 7.5 × 2 in each
(2 elements)
- 7
Deathwings, 2025
Ear candles, clothes, paint,
grommets, hot glue
~66 × 41 × 11 in
(1 element)
~89 × 48 × 11 in
(1 element)
- 8
Angel Voices, 2025
Cast aluminum, aluminum
foil wrappers
~1.5 × 2.75 × 1 in each
(30 elements)
- 9
Forever, 2025
Disco ball motors, D batteries,
metal heart ornaments
~4.5 × 4.5 × 25 in each
(21 elements)
- 10
Warmer, 2025
Portable heaters, propane tanks
Dimensions variable
(4 elements)

Nancy Lupo (b. 1983 Flagstaff, Arizona) lives and works in Berlin. Lupo studied at the Cooper Union (New York) and Yale University (New Haven), and later participated in residency programs at the Skowhegan School of Painting and Sculpture, Tbilisi Propaganda Residency, and Casa Wabi. Solo exhibitions of her work have been held at galleries and institutions including Kristina Kite (Los Angeles), VEDA (Florence), Dawid Radziszewski (Warsaw), MORAN MORAN (Mexico City), Sydney (Sydney), 1857 (Oslo), Visual Arts Center at the University of Texas at Austin, and Swiss Institute (New York). Her work has also been included in national and international group exhibitions, including at the Aspen Art Museum, Hiroshima City Museum of Contemporary Art, Museum of Contemporary Art, Rome, Neuer Kunstverein Wien (Vienna), MAK Center for Art and Architecture (Los Angeles), Palais de Tokyo (Paris), and Astrup Fearnley Museet (Oslo). Current solo exhibitions include *Princessletthewind* at Kunstverein für Mecklenburg und Vorpommern (Schwerin) and *Our Villas* at apollo. Since 2024, Nancy Lupo has been a professor of sculpture at the Kunsthochschule Mainz.