

Burkhard Beschow — *Elevation and Elevation Drawing*
June 6th – July 12th

The exhibition brings together two artworks: *Elevation* (2024-25) and *Elevation Drawing* (2025).

The monitors used in *Elevation* are common in broadcasting environments. Simultaneous camera feeds can be monitored while the foldability and rack-size allows for field use.

The video itself consists of photographs taken through the perforations in steel barricades used to seal off abandoned properties as a temporary measure. The photographed buildings are all part of the German railway infrastructure and were abandoned over the past thirty years. Over twenty decommissioned places within a hundred-mile radius of Berlin are included in the twenty-four-minute sequence.

Each scene follows a row of holes across the steel surface, up, down, left, right, often revisited on a later trip. Each frame is a view through a hole. Light conditions change during the scanning process. Sunlight and station light take turns. The holes filter brightness into luminous patterns, irradiating and belaboring the shadowy condition – but not for anyone to see.

Elevation Drawing focuses on these patterns. It uses the monitor as a source, continuing the photographic scanning with pencil tracing. The work takes its title from a certain format of architectural drawing, where houses are depicted from a fixed, frontal perspective...

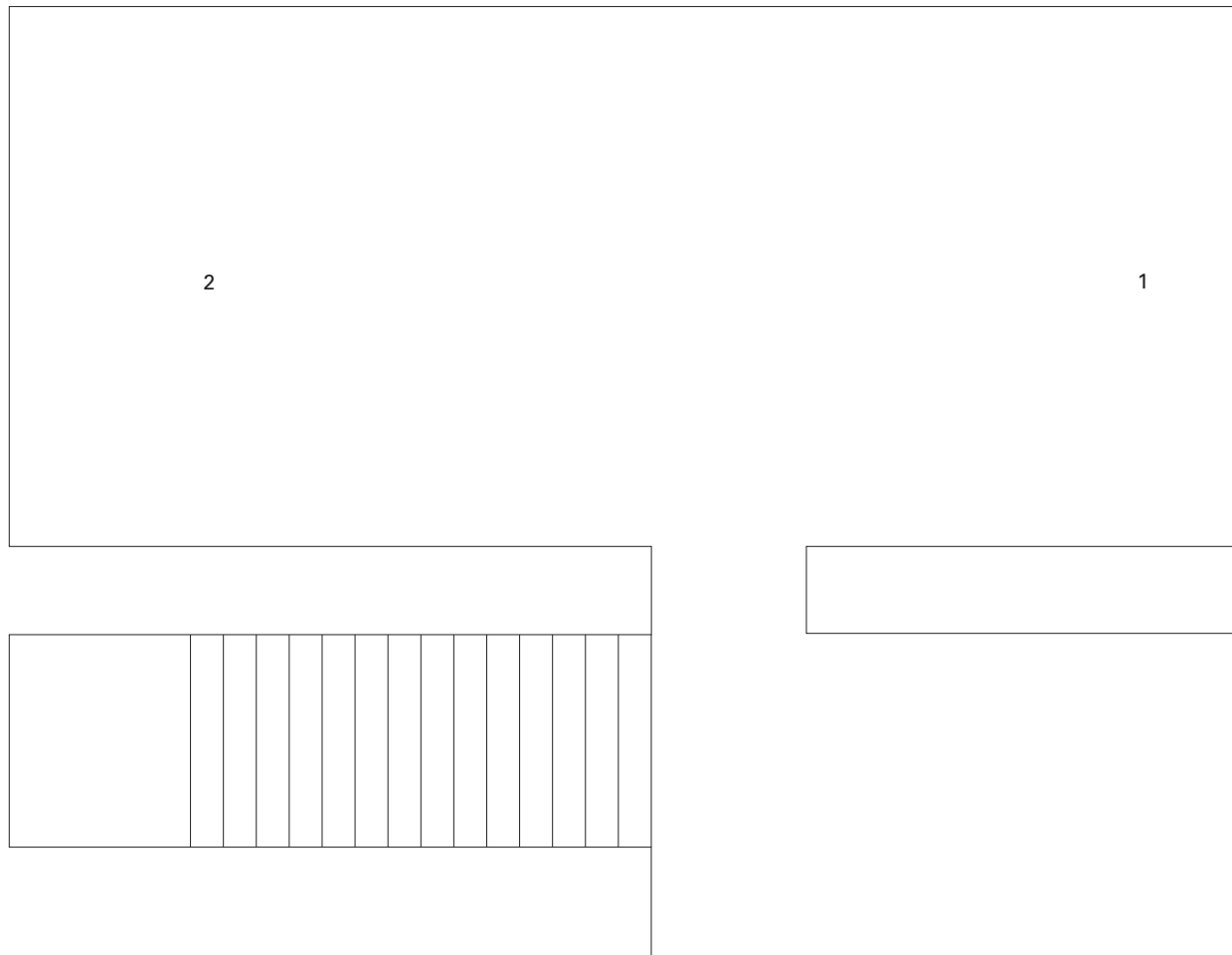

1. *Elevation Drawing*

Pen, pencil, and erasible ink on notebook paper, watercolor paper, sign board, pins
45 3/4" x 48 1/2"
2025

2. *Elevation*

Dual-screen broadcast monitors, custom pedestals
Video duration: 24 minutes
Dimensions: variable
2024-2025