

ASEF-BURCKHARDT MOTHER-BURN



6.06–6.07.2025

CURATOR: BARTOSZ NOWAK

MIEJSKI OŚRODEK SZTUKI
UL. POMORSKA 73, GORZÓW WLKP.
MOSART.PL

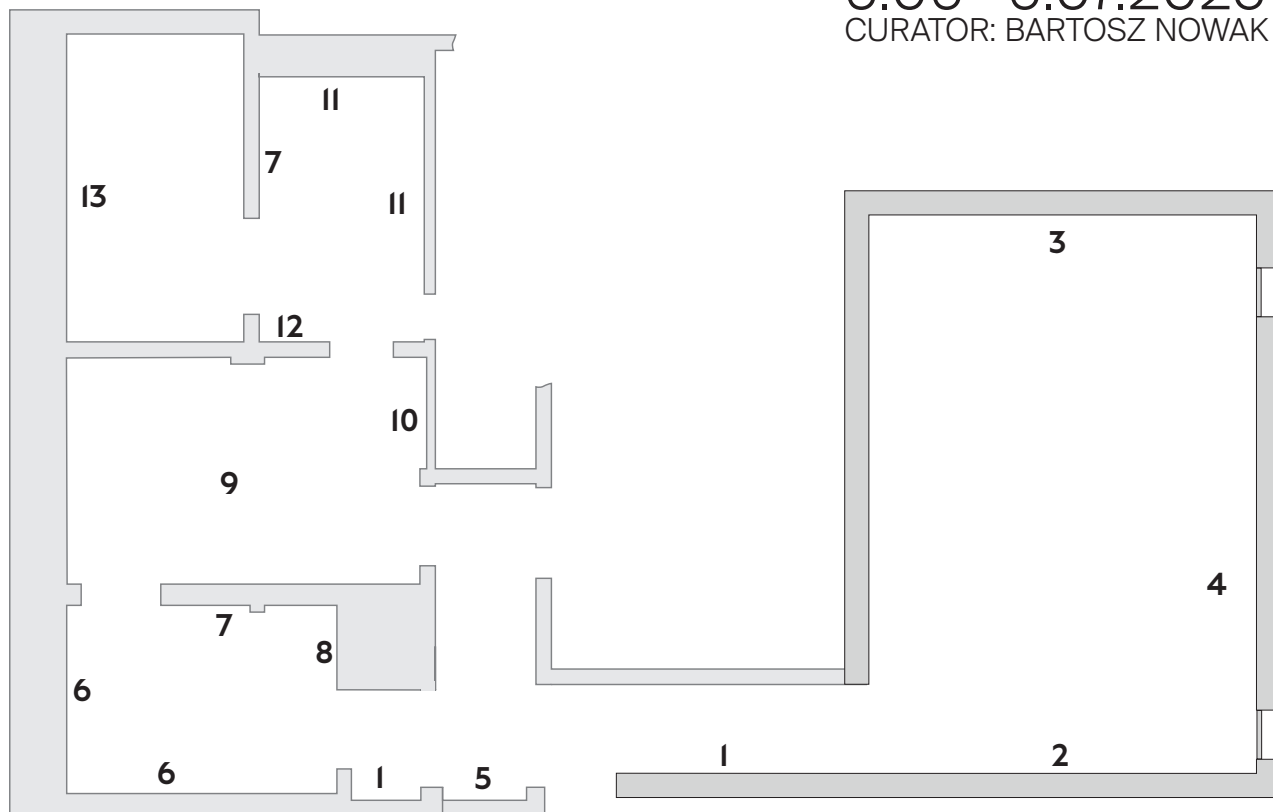

- 1 *Personal Archive*, mixed media, dimensions variable, on walls and vitrines and photodisplay, since 2023
- 2 *SHELTER-BONE*, drawings, ink on paper, led lamps, 40 x 30 cm, 2024
- 3 *SHELTER-BONE (To Anna and Lawrence Halprin at The Sea Ranch)*, video, 27'39", 4K, stereo, color, 2024
- 4 *Model Barn*, cardboard, tape, 45 x 65 cm, 2025
- 5 *Hand-Charcoal-Song*, video, 9'48", 4K, stereo, color, flat screen 2024
- 6 *Script*, installation, poems (translated), photography 16:9, Alu-Dibond, 2025
- 7 *Ink and Dead Organisms on Paper*, mixed media on paper, 40 x 30 cm, 2023
- 8 *Environments 2: Tintinnabulation*, found object at family home, archive, 1970
- 9 *In Between Before and After*, sound installation, paper, transducers, ropes, redwood charcoal, dimensions variable, 2024
- 10 *Burned Song*, performance garment, textile, rope, 2025
- 11 *Oil and Discarded Matter on Canvas*, mixed media on canvas, 160 x 200 cm and 160 x 300 cm, 2025
- 12 *Hedgerow House*, photo and drawing, 45 x 30 cm, 2024
- 13 *MOTHER-BURN*, video, 23'33", 4K, stereo, color, 2025

"MOTHER-BURN" is the second video of a trilogy by the artist-couple Asef-Burckhardt. It was filmed on-site in the burned remains of a Redwood tree grove in the ecologically avantgarde architecture project "The Sea Ranch" in Northern California. Based on extensive periods of research there, Asef-Burckhardt created videos, drawings, paintings, performance, sound, photographs and poems produced on site and in Berlin. Their multimedia project is continuously expanding and shown in changing settings at exhibition venues in different countries.

Against the acute backdrop of the global environmental crisis, new anthropological questions such as 'What must architecture connect today?' and 'What must love achieve today?' are raised and artistically explored in close relation to the real topography of the The Sea Ranch. Situated in the north of San Francisco, The Sea Ranch is a 10 mile strip of land with clustered residential buildings which are integrated into the sharp cliffs of the Pacific. Strong, saltsoaked winds from the sea, rugged rocks in fine sand and ancient redwood forests characterise the landscape here. The masterplan for this territory was developed by the landscape architect Lawrence Halprin in collaboration with the four architects Richard Whitaker, Donlyn Lyndon, Charles Moore, and William Turnbull in the 1960s. To invigorate community building, Lawrence developed workshops together with his wife, the choreographer Anna Halprin. Since then, the estate has continued to grow and still sets international standards for the interplay between architecture and nature – in other words, 'protection' and 'environment'. But what remains of the Halprins' utopia at the time "to live lightly on the land" and the idealism of a sensitive approach to the environment for us today?

Asef-Burckhardt's multi-layered approach is inspired by the Halprin couple and the elements of The Sea Ranch pacific coast: rough ocean alongside burned forest. So far, Asef-Burckhardt have been showing their works in dialogue with the rugged sea and the political implications of this settlement. For their first solo exhibition in Poland, they are now also unfolding how their project touches upon the wildfires in ancient redwood forests.

Kirstin Burckhardt (born in Durban, South Africa) is a visual artist and psychotherapist who combines video and performance with sound and spoken word. Drawing on her training in psychology and neuroscience, her work critically explores the power dynamics interwoven with the body. By constantly questioning what constitutes a 'body', her artistic research focuses on the interpersonal space as a site for negotiating sensitivity, conflict, empathy, transgenerational trauma and the complexity of healing.

More information: www.k-burckhardt.de

Mario Asef (born in Córdoba, Argentina) is a Berlin-based architect and conceptual artist. Flanked by his extensive expressive possibilities in acoustics and moving image, his projects mainly deal with theoretical and materialised constructions of humanoid-cultivated space, be it the built city or the domesticated landscape. He is also particularly interested in the ecological systems of microorganisms such as lichens and fungi, which form the generative basis of our planet's flora and fauna.

More information: www.marioasef.net