

SLIPPERY LIKE MANGO JUICE

ELLA BERTILSSON

4 SEPTEMBER - 4 OCTOBER, 2025

The Horse is excited to share the solo exhibition SLIPPERY LIKE MANGO JUICE by Dublin based, Swedish born artist Ella Bertilsson. The show is a survey of recent work that draws us through her exploration of aesthetics and attachment to objects, actions and vignettes, drawn from life experiences. Bertilsson's practice constructs a world with its own visual tropes; the results are delicately composed and viscerally fresh works operating at the intersection of unfettered dreams and conceived thoughts.

In the centre of the gallery is a cactus dancer - these frantic objects are normally used for roadside advertising (things like car washes). The noise from the fan overwhelms the room (white noise) and the air pushes the cactus to (hopefully) dance around the room. The walls are hung with groups of drawings and paintings that dictate short allegories, mantras, peculiar characters and landscapes.

Concurrently Bertilsson presents a series of sculptures, these are made from modifying angry birds, wigs and mops and brushes. These masks evoke a ritualistic apparatus, performative wear. The veiling of the human face does not make them any less human - they push you into strong but abstract idea of persona.

Perhaps the most direct reflection in the works, the video is an exploration of intimate thought bubbles; it documents the passage down a river bed in LA, leading from Mid-city to Marina Del Ray. Concrete covered in unsanctioned drawings, a stark human-made environment that is essential to domestic life but utterly absent from it day-to-day.

SLIPPERY LIKE MANGO JUICE as a singularity puts order to the (somewhat overwhelming) exhaust from consumerism, popular culture, personal metaphors, thoughts and feelings: The semiotic markers of these things produce a collective memory. A menagerie of familiar things like mops, stuffy toys, cycle paths, Angry Birds, Car Wash (1976), diary entries, wigs, felt tipped pens, white noise, internal monologue, logos, personas.

Born in Umeå, Northern Sweden (1982), Ella Bertilsson works in Dublin and Kilkenny, Ireland. Bertilsson is currently a member at Temple Bar Gallery and Studios and is recognised as a Next Generation Artist by The Arts Council of Ireland. Her practice incorporate narrative-based installations, sculpture, film, performance, sound, drawing and painting.

Selected solo exhibitions include: Ballina Art Centre, Mayo (2024); The Dock, Leitrim (2023-24) and The Complex, Dublin (2022). Selected group shows include: Temple Bar Gallery & Studios Dublin (2025); Hjortens Skulptur Park, Stockholm SWE (2025), Rua Red Gallery, Dublin (2024-2025); Charlemont Square, Dublin (2024); Luan Gallery, Athlone (2024); The Lab Gallery, Dublin (2024) and The Library Project, Dublin (2023). Selected performances: Linen Hall, Mayo (2025); 126 Gallery, Galway (2024); TBG+S, Dublin (2024); Galway Art Centre, Galway (2023) and IMMA, Dublin (2023).

Ella holds two first class honours in Fine Art Print (BA) and MFA; Art in The Digital World, both awarded from the National College of Art and Design, Ireland 2009 and 2015, and Comparative Literature Studies and Creative Writing from Södertörn University SWE 2012.

www.ellabertilsson.net

Founded in 2021 The Horse is an artist run contemporary art gallery in Dublin 1 that seeks to provide a platform for emerging, experimental and underrepresented art practitioners. For sales, viewings and programming in general, please email Matthew Wilkinson – mw@thehosedublin.xyz

ELLA BERTILSSON

4 SEPTEMBER - 4 OCTOBER, 2025

1 *FULL MOON SHINING*
(2025)
paint marker on paper
32 x 40 cm

2 *FUCK ME BOOTS*
(2025)
paint marker on paper
32 x 40 cm

3 *GRUMPY FRIEND*
(2025)
paint marker on paper
32 x 40 cm

4 *FATE ALL THE WAY HOME*
(2025)
paint marker on paper
32 x 40 cm

5 *HEADS*
(2025)
six stuffy toy bird heads, wigs, sunglasses
dimensions variable

6 *REMEMBER: SUPPORT IS EVERYWHERE!*
(2025)
ink marker on paper
(4 x) 37.5 x 45 cm

7 *BANANA SPLIT 1991*
(2025)
acrylic, spray paint, oil pastel, pencil on canvas
160 x 130 cm

8 *THE BIG FINGER*
(2025)
paint and ink marker on paper
32 x 40 cm

9 *ANGEL - SOMMAREN I CITY*
(2025)
paint and ink marker on paper
32 x 40 cm

10 *BEAR TRAP*
(2023)
acrylic, spray paint, oil pastel,
paint marker on canvas
160 x 130 cm

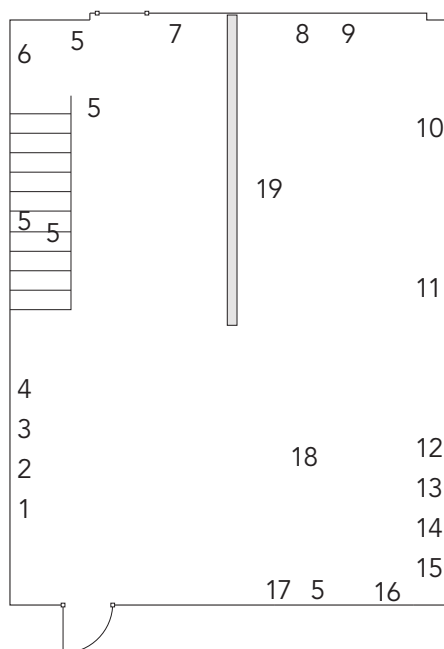

11 *MOP CHARACTERS*
(2025)
wig masks, bunny ears, dust mop
two sweeping brushes, frog tape,
paper, wool fabric
dimensions variable

12 *CAT POSTER MISSING*
(2025)
acrylic paint, indian ink, ink
marker on paper
37.5 x 45 cm

13 *VAMPIRES HUNT SOFT HEARTS*
(2025)
acrylic paint, indian ink, ink
marker on paper
37.5 x 45 cm

14 *JUST A BIT OF CARPET*
(2025)
acrylic paint, indian ink, ink marker on paper
37.5 x 45 cm

15 *BRING MILK HOME*
(2025)
acrylic paint, indian ink, ink marker on paper
37.5 x 45 cm

16 *SLIPPERY LIKE MANGO JUICE*
(2025)
acrylic paint, indian ink, ink marker on paper
37.5 x 45 cm

17 *MELTING FACE*
(2025)
paint marker on paper
32 x 40 cm

18 *BROKEN HEART CREEK*
(2025)
CRT monitor, 64 orange Lucozade bottles
PAL, Stereo, dur 14.18

19 *CACTUS DANCER*
(2025)
synthetic material, fan, paint marker
dimensions variable