

# dépendance

4 rue du marché aux porcs  
1000 brussels  
t +32 2 217 74 00  
www. dependance.be  
info@dependance.be

**THOMAS BAYRLE**  
14 March - 11 April, 2026

Press Release

dépendance is pleased to present the fourth solo exhibition of Thomas Bayrle at the gallery. The exhibition coincides with his surveys at the Schirn Kunsthalle in Frankfurt (12 February - 10 May) and the MiK in Würzburg (28 February - 17 May 2026) and consists of a dozen works on paper from the early 1970s and two new tapestries.

Thomas Bayrle is an influential figure among Germany's post-war artists. He has been examining societal transformations since the 1960s, often emphasizing the interconnectedness between individual behavior and collective systems. He came of age during the West German economic miracle, when production was not hidden but displayed and promised as a new normal. During a textile apprenticeship, he learned pattern making on Jacquard looms whose punch cards thought in units and commands. That early encounter with the grid never left him. Across drawings, prints and objects Bayrle treats repetition as both craft and critique, showing how images, language, and everyday things are shaped by economic and political systems.

A suite of drawings from 1970 to 1973 makes the machine visible in a different way, by slicing the motif into bands. *Hat* and *Der Boss* appear out of horizontal lines like forms scanned into being, the hand imitating a programmed process with patience. Some of the drawings are outlines for his signature prints, such as *Beethoven "Mondscheinsonate"* and *Schwein Herta*. Bayrle once remarked that he works in awareness of the machine, that it stands beside him and influences him. *Parkhaus* applies the same banded thinking to infrastructure, a parking block that holds a car, an image of storage and stalled motion that echoes his attention to highways and traffic systems. In these works the line is never innocent. It behaves like a register or a track.

The line drawings return to the textile surfaces of the carpets. The picture becomes fabric again, a field you encounter with your body as much as your eyes. Bayrle has often pointed to Jacquard pattern cards as a precursor of digital programming, insisting that the analog and the digital occupy adjacent realms. The carpet is therefore not a retreat from technology but its quiet twin. Thread stands in for code. The loom anticipates the screen.

-  
Thomas Bayrle (1937, Germany) lives and works in Frankfurt. He has held major solo exhibitions at New Museum, New York; MAK, Vienna; Institute of Contemporary Art, Miami; Lenbachhaus, Munich; WIELS, Brussels; MADRE, Naples; Musée d'art Moderne et Contemporain, Geneva; Museum Ludwig, Cologne and Museum für Moderne Kunst, Frankfurt. He has also shown at the 50th and 53rd Venice Biennale, the 16th Biennale of Sydney, the 4th Berlin Biennale and the 2nd Guangzhou Triennial. He took part in documenta 3, documenta 6 and documenta 13 when he won the Arnold-Bode-Preis. From 1975 till 2007, he was a professor at the Städelschule.

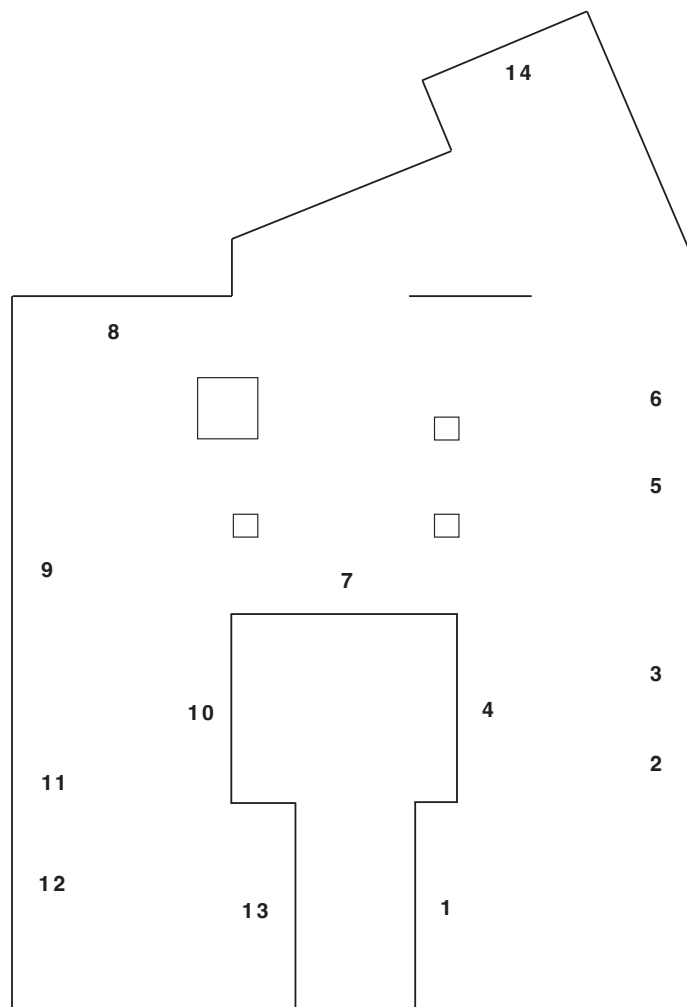

- 1 **Untitled**, 1987  
watercolor and pencil on cardboard, unframed  
58.5 x 50.8 cm / 23 x 20 in
- 2 **Hat**, 1970  
Pencil and felt-tip pen on vellum paper, framed  
60.5 x 54 x 4.2 cm (framed)  
23 7/8 x 21 1/4 x 1 5/8 in (framed)
- 3 **Colosseum**, 1970  
Pencil and felt-tip pen on vellum paper, framed  
59 x 78 x 4.2 cm (framed)  
23 1/4 x 30 3/4 x 1 5/8 in (framed)
- 4 **Hat**, 1970/2026  
woven carpet  
140 x 140 cm / 55 1/8 x 55 1/8 in
- 5 **Mannes-Mann**, 1972  
Pencil and felt-tip pen on vellum paper, framed  
49.7 x 41 x 3.7 cm (framed)  
19 5/8 x 16 1/8 x 1 1/2 in (framed)
- 6 **Parkhaus**, 1973  
Pencil and felt-tip pen on vellum paper, framed  
41 x 51 x 3.7 cm (framed)  
16 1/8 x 20 1/8 x 1 1/2 in (framed)
- 7 **Untitled**, 2004  
ink and pencil on paper, unframed  
42 x 102 cm / 16 1/2 x 40 1/8 in
- 8 **Der Boss**, 1971/2026  
woven carpet  
140 x 140 cm / 55 1/8 x 55 1/8 in
- 9 **Beethoven**, 1970  
Pencil and felt-tip pen on vellum paper, framed  
49.7 x 41 x 3.7 cm / 19 5/8 x 16 1/8 x 1 1/2 in (framed)
- 10 **Gelb I**, 2012/14  
cardboard, wood, gouache  
60.5 x 50 x 4 cm / 23 7/8 x 19 3/4 x 1 5/8 in
- 11 **Der Boss**, 1971  
Pencil and felt-tip pen on vellum paper, framed  
61 x 59 x 4.2 cm / 24 x 23 1/4 x 1 5/8 in (framed)
- 12 **Herta**, 1972  
Pencil and felt-tip pen on vellum paper, framed  
49 x 61.5 x 4.2 cm / 19 1/4 x 24 1/4 x 1 5/8 in (framed)
- 13 **Cowboy**, 1970  
pencil on transparent paper, framed  
46.0 x 58.0 cm / 18.1 x 22.8 in
- 14 **Bügelmann (Rot)**, 1970  
silkscreen in 4 colors on cardboard  
50.0 x 71.0 cm / 19.7 x 28 in  
Edition 32 of 50