

Milano Chow, William Leavitt, Nancy Lupo, Liliana Porter, Benjamin Reiss, Paul Salveson, Ana Tiscornia, Eric Veit **The Props assist the House** Aug 3 - Sept 14, 2019

- 1 William Leavitt
Installation Kit (Molecule), 2009
lithograph
- 2 William Leavitt
Installation Kit (Wall), 2009
lithograph
- 3 William Leavitt
Installation Kit (Lamp), 2009
lithograph
- 4 Nancy Lupo
OV One, 2015-2017
Magic-Sculpt, ice trays, barley greens powder, calcium carbonate, acrylic binder, UV sealer, fibered aluminum roof coating
- 5 Nancy Lupo
CW Two, 2015-2017
Magic-Sculpt, ice trays, barley greens powder, calcium carbonate, acrylic binder, UV sealer, fibered aluminum roof coating
- 6 Eric Veit
Daffodil Tulip Steak, 2018
wood, enamel
- 7 Liliana Porter
Bell House, 2006
digital photograph
- 8 Milano Chow
Three Columns with Leaning Figure, 2019
graphite, ink, vinyl paint, and photo transfer on paper
- 9 Milano Chow
Night Scene with Silhouettes, 2019
graphite, ink, vinyl paint, and photo transfer on paper
- 10 Liliana Porter
The Sign, 2018
metal object and figurine

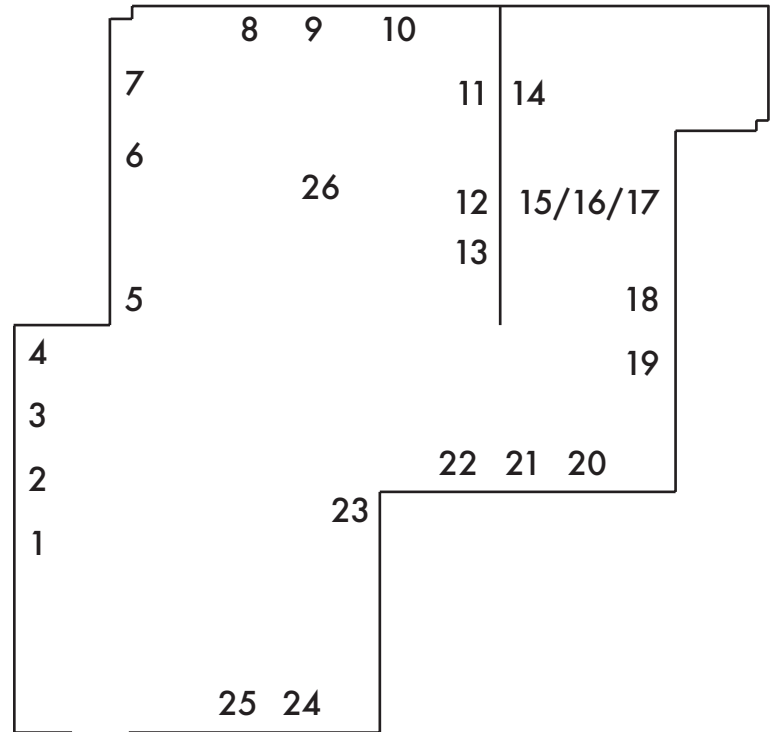

- 11 Paul Salveson
Failed Conversion, 2019
paper, ball bearings, wood
- 12 Liliana Porter
The Red Box, 2019
acrylic on vintage book with attached figurine
- 13 Liliana Porter
The Book, 2018
acrylic on vintage book
- 14 Eric Veit
Better for Earth, 2019
wood, shellac, plaster, wine foil, resin, plastic, wine, silver



- 15** Benjamin Reiss
Writing Table, 2018
pine, oak, basswood, MDF, paint, glue, steel
- 16** Paul Salveson
Untitled, 2018
paper, acrylic, wood, ball bearings, wood glue
- 17** Eric Veit
Sweet Potato Baby Doll, 2019
wood, shellac, plastic, chocolate foil, resin
- 18** Paul Salveson
Elastic Mask, 2018
paper, jawbreakers, wood
- 19** Paul Salveson
Ideal Configuration, 2019
paper, jawbreakers, wood
- 20** Ana Tiscornia
It was next to the rug, 2019
acrylic, plaster, digital print, mosaic, wood
- 21** Ana Tiscornia
Side by side, 2019
acrylic, plaster, fabric
- 22** Ana Tiscornia
Remaining flowers, 2018
acrylic, plaster, paper, wood
- 23** Nancy Lupo
REG Two, 2015-2017
Magic-Sculpt, ice trays, barley greens powder, calcium carbonate, acrylic binder, UV sealer, fibered aluminum roof coating
- 24** Liliana Porter
The Unravel (green thread), 2019
figurine and thread spool on white shelf
- 25** Paul Salveson
Drupe, 2019
paper, jawbreakers, plastic bags, wood
- 26** Ana Tiscornia
Rug and chair, 2017
digital print on fabric and wood

